

MEMOPOWER- III Series

1:1 Phase PF 0.9 (PF 0.8/1.0 optional)

Power range: 1kVA~3kVA



Features

- High power density
- Online double conversion with full digital control
- Wide input voltage range: 110~300Vac
- Input power factor 0.99 with PFC
- Selectable output voltage: 208/220/230/240Vac
- Smart charger design for optimized battery performance
- Maximum charging current can be expanded to 12A (Long run unit)
- Emergency power off function (EPO)
- ECO mode operation for energy saving
- Generator compatible
- Cold start
- Intelligent fan speed regulation
- Load segment settable (Optional)
- Versatile LCD human-computer interface
- Multiple communication interface: RS232 (USB/EPO/Dry contact /SNMP card optional)
- Multiple protection function: short-circuit, overload, overheat, battery overcharge and overdischarge, output low voltage and fan fault alarm

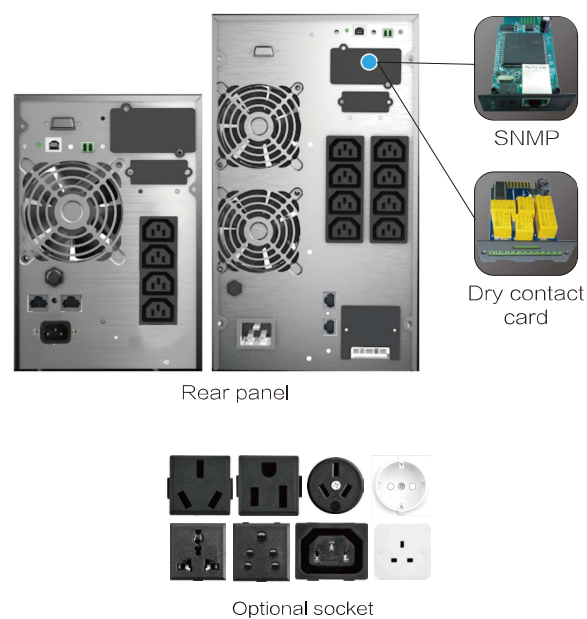

Technical Specifications:

MODEL		MP 1k H		MP 1k S		MP 2k H		MP 2k S		MP 3k H		MP 3k S	
Capacity		1000VA/ 900W				2000VA/ 1800W				3000VA/ 2700W			
INPUT													
Nominal voltage		208/220/230/240Vac											
Input voltage range		110~300Vac (176~280Vac @ 100% load)											
Frequency range		40~70Hz (50/60Hz Auto-Sensing)											
Power factor		≥0.99											
OUTPUT													
Output voltage		208/220/230/240Vac											
Power factor		0.9											
Voltage regulation		± 1%											
Output frequency	Line Mode	46~54Hz or 56~64Hz											
	Bat. Mode	(50/60 ± 0.1%)Hz											
Crest factor		3:1											
Harmonic distortion (THDv)		≤3% Linear load ≤5% Non linear load											
Transfer time	AC mode to Bat.Mode	0ms											
	Inverter to Bypass	4ms (Typical)											
Output waveform		Pure Sinewave											
EFFICIENCY													
AC mode		88%				90%				91%			
Battery mode		85%				87%				88%			
BATTERY													
Battery number		2	3	2	3	4	6	4	6	6	8	6	
Capacity (Standard unit)		9Ah/12V											
Typical recharging time		4 hours (to 90% of full capacity)											
Charging voltage		27.4Vdc ± 1%	41.1Vdc ± 1%	27.4Vdc ± 1%	41.1Vdc ± 1%	54.8Vdc ± 1%	82.2Vdc ± 1%	54.8Vdc ± 1%	82.2Vdc ± 1%	82.2Vdc ± 1%	109.6Vdc ± 1%	82.2Vdc ± 1%	
Charging current (Max)		6A/12A		1A		6A/12A		1A		6A/12A		1A	
INDICATORS													
LED display		Line mode,Bat.mode,ECO mode,Bypass mode,Battery low voltage,Overload & UPS fault											
LCD display		Input voltage,Input frequency,Output voltage,Output frequency,Load percentage, Battery voltage,Inner temperature& Remaining battery backup time											
ALARM													
Battery mode		Beeping every 4 seconds											
Battery low		Beeping every second											
Overload		Beeping twice every second											
Fault		Continuously beeping											
PHYSICAL													
Dimension W x D x H (mm)		144 x 293 x 209			144 x 399 x 209			191 x 460 x 337					
Net weight (kg)		4.1		9.3	12.5	10		19.5	24.5	10		24.5	
ENVIRONMENT													
Operating temperature		0℃~40℃											
Storage temperature		-25℃~55℃											
Humidity range		20~95%RH @ 0~40℃ (Non condensing)											
Altitude		<1500m,derating required when>1500m											
Noise level		<50dB at 1 Meter											
STANDARDS													
Safety		IEC/EN62040-1,IEC/EN62477-1											
EMC		IEC/EN62040-2,IEC61000-4-2,IEC61000-4-3,IEC61000-4-4,IEC61000-4-5,IEC61000-4-6,IEC61000-4-8											

Specifications are subject to change without prior notice.
When output voltage is 208Vac,need to derate to 80% of the unit capacity.

MP BT 1–3kVA battery pack specification

MODEL	MP BT04024C	MP BT06036C	MP BT08048C	MP BT12072C	MP BT16096C
BATTERY SYSTEM					
Battery tpye	VRLA (Lead acid maintenance free battery)				
Typical battery recharging time	6~8 hours (to 90% of full capacity)				
Typical battery life	3~5 years,depend on discharing cycle and ambient temperature				
System voltage	24Vdc	36Vdc	48Vdc	72Vdc	96Vdc
Charging current (Max)	1.4A				
Battery quantity	4	6	8	12	16
Capacity	9Ah/12V (7Ah/12V optional)				
PHYSICAL					
Dimension W x D x H (mm)	144 x 399 x 209			191 x 460 x 337	
Net weight (kg)	13.5	18.5	28.5	38.5	47.5
ENVIRONMENT					
Safety	CE				
Operating environment	0℃~40℃				
Relative humidity	0~95% (Non condensing)				
Noise level	<40dB at 1 Meter				

Specifications are subject to change without prior notice.

Remark: MP BT08048C "MP" means series; "BT" means Battery Tower cabinet; "08" means battery number inside the cabinet; "048" means the battery system voltage; "C" means the cabinet coming with charger.