

Switching Mode Power Supply

PWR-DC1208-C16-EU



Specifications

Model	PWR-DC1208-C16-EU
Power	
Appearance	White
Input	200 to 240 VAC, 47 to 63 Hz
Output	12VDC, 96W Max Total, 1A Max per Channel
Cable Length Compensation	Normal: 12 VDC Long: 13.5 VDC Ex-Long: 15 VDC
Ripple and Noise	0.15 Vp-p (150 mV)
AC Input Connector	C8
DC Output Connector	DC Plug: grid terminal
LED Indicator	Green
Certification	CE
Operating environment	0°C to 40°C (32°F to 104°F), ≤90% (non-condensing)
Storage environment	-20°C to 70°C (-4°F to 158°F), ≤95% (non-condensing)

Dimensions

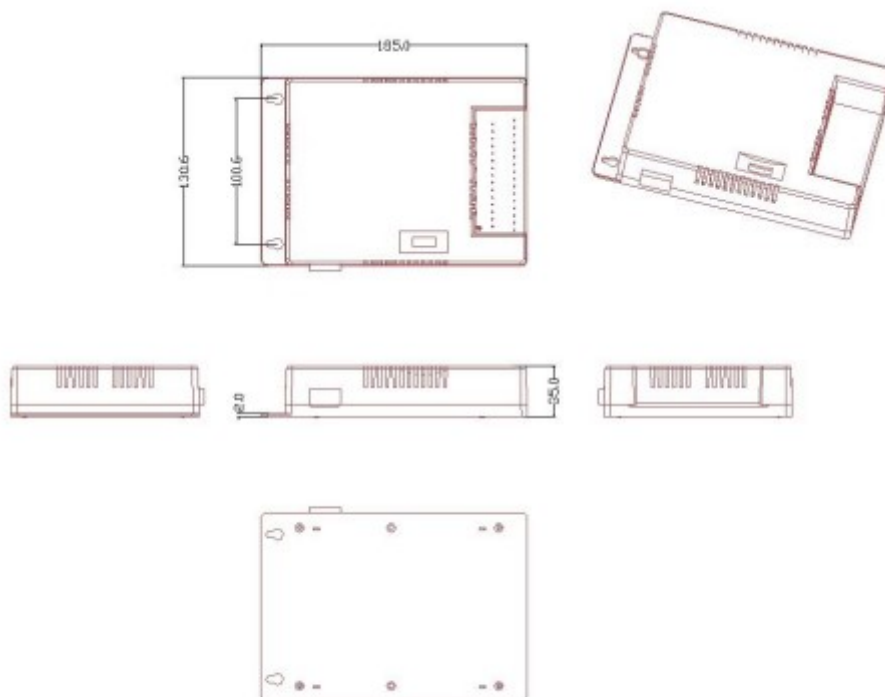

Zhejiang Uniview Technologies Co., Ltd.

- <http://www.uniview.com>
- overseasbusiness@uniview.com; globalsupport@uniview.com
- No. 369, Xietong Road, Xixing Sub-district, Binjiang District, Hangzhou City, 310051, Zhejiang Province, China



©2023-2025 Zhejiang Uniview Technologies Co., Ltd. All rights reserved.
*Product specifications and availability are subject to change without notice.
*Despite our best efforts, technical or typographical errors may exist in this document.
Uniview cannot be held responsible for any such errors and reserves the right to change the contents of this document without prior notice.